

CILINDRI CON ATTACCHI AD OCCHIO FISSO

CYLINDER TYPE FIXED EYE

ZYLINDER SERIE FESTAUGE

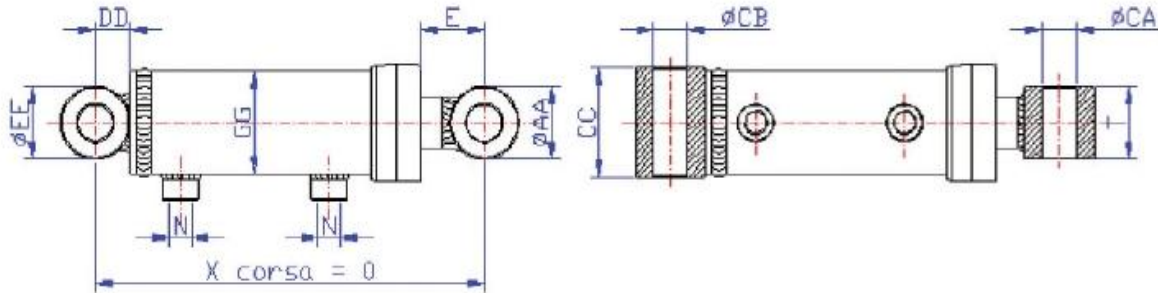

| ALES | STEL | T | CA | AA | CB | CC | DD | EE | E | GG | N | X |
|------|------|-----|----|----|-----|-----|----|----|-----|-----|-----|-----|
| 100 | 50 | 80 | 50 | 80 | 50 | 120 | 40 | 80 | 70 | 110 | 1/2 | 270 |
| | 55 | 80 | 50 | 80 | 50 | 120 | 40 | 80 | 70 | 110 | 1/2 | 270 |
| | 60 | 80 | 50 | 80 | 50 | 120 | 40 | 80 | 60 | 110 | 1/2 | 270 |
| 110 | 50 | 80 | 50 | 80 | 50 | 135 | 40 | 80 | 80 | 125 | 3/4 | 280 |
| | 55 | 80 | 50 | 80 | 50 | 135 | 40 | 80 | 80 | 125 | 3/4 | 280 |
| | 60 | 80 | 50 | 80 | 50 | 135 | 40 | 80 | 70 | 125 | 3/4 | 280 |
| | 70 | 80 | 50 | 80 | 50 | 135 | 40 | 80 | 70 | 125 | 3/4 | 280 |
| 125 | 50 | 80 | 50 | 80 | 50 | 155 | 40 | 80 | 70 | 145 | 3/4 | 280 |
| | 55 | 80 | 50 | 80 | 50 | 155 | 40 | 80 | 70 | 145 | 3/4 | 280 |
| | 60 | 80 | 50 | 80 | 50 | 155 | 40 | 80 | 80 | 145 | 3/4 | 280 |
| | 70 | 80 | 50 | 80 | 50 | 155 | 40 | 80 | 80 | 145 | 3/4 | 280 |
| | 80 | 100 | 50 | 80 | 50 | 155 | 40 | 80 | 80 | 145 | 3/4 | 290 |
| 140 | 90 | 100 | 50 | 80 | 50 | 155 | 40 | 80 | 80 | 145 | 3/4 | 290 |
| | 50 | 80 | 50 | 80 | 50 | 165 | 40 | 80 | 70 | 160 | 3/4 | 280 |
| | 55 | 80 | 50 | 80 | 50 | 165 | 40 | 80 | 70 | 160 | 3/4 | 280 |
| | 60 | 80 | 50 | 80 | 50 | 165 | 40 | 80 | 80 | 160 | 3/4 | 280 |
| | 70 | 80 | 50 | 80 | 50 | 165 | 40 | 80 | 80 | 160 | 3/4 | 280 |
| | 80 | 100 | 50 | 80 | 50 | 165 | 40 | 80 | 80 | 160 | 3/4 | 290 |
| 90 | 100 | 50 | 80 | 50 | 165 | 40 | 80 | 80 | 160 | 3/4 | 290 | |